

# REPLACEMENT PARTS SUITABLE FOR Hypertherm®

HPR®130/HPR®260  
Torches and Cable leads

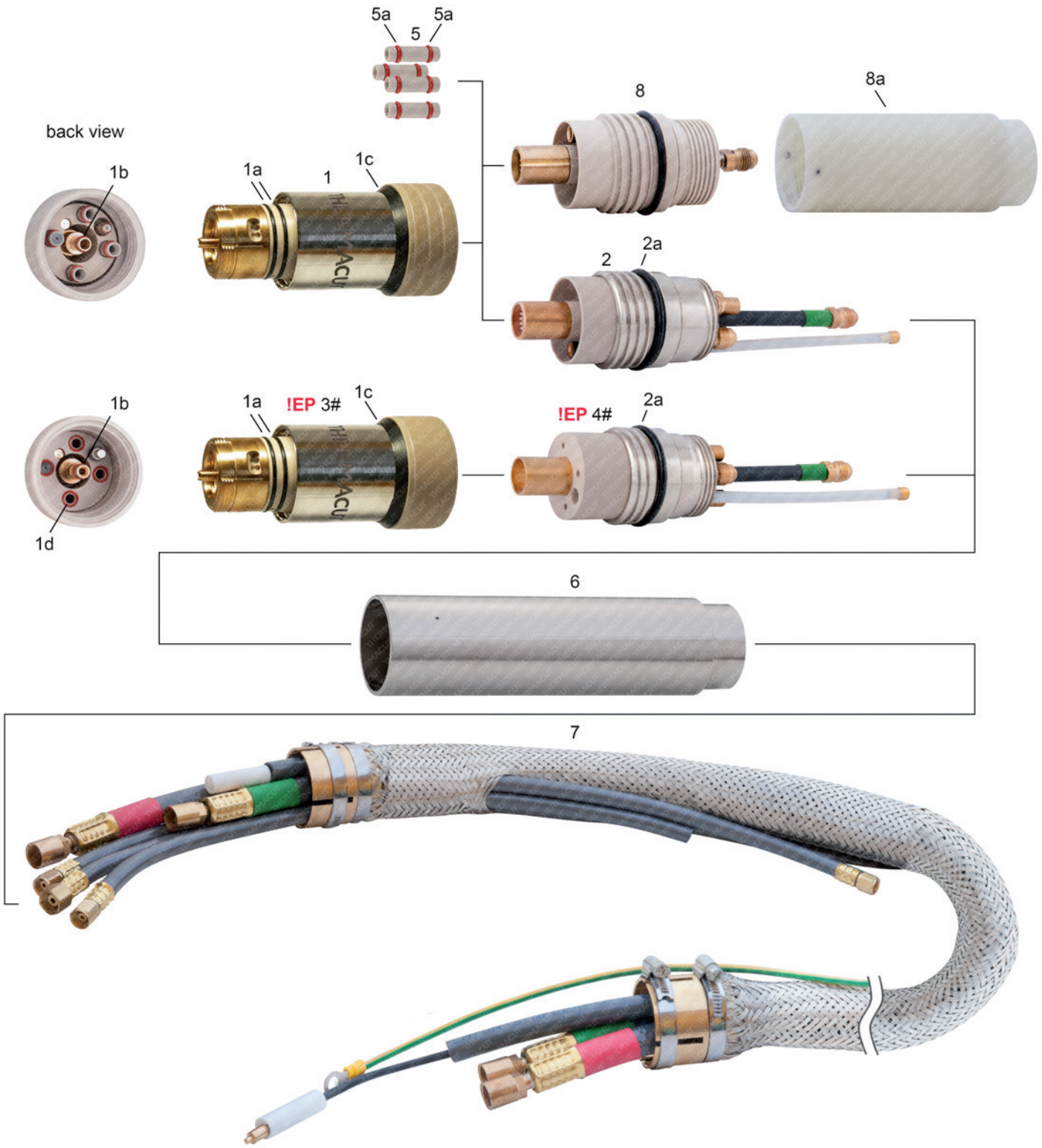

Last update of this page: 02/09/2016. See Revision history for details.

**THERMACUT®**  
THE CUTTING COMPANY

WWW.THERMACUT.CZ  
TEL.: +420 556 423 418  
SALES@THERMACUT.CZ

WWW.THERMACUT.DE  
TEL.: +49 (0) 27 39 40 33 0  
INFO@THERMACUT.DE

WWW.THERMACUT.COM  
TEL.: 1-603-542-6715  
CUSTOMERSERVICE@THERMACUT.COM

THERMACUT®, FHT-EX® AND EX-TRAFIRE® ARE REGISTERED TRADEMARKS OF THERMACUT S. R. O. AND MAY BE REGISTERED IN CZECH REPUBLIC AND/OR OTHER COUNTRIES. ALL OTHER TRADEMARKS ARE PROPERTIES OF THEIR RESPECTIVE OWNERS. THERMACUT IS NO WAY AFFILIATED WITH Hypertherm®. MOST THERMACUT PARTS ARE MADE FOR OR BY AN IBG COMPANY. PARTS INDICATED WITH A OEM ARE ORIGINAL PARTS MANUFACTURED BY THE ABOVE NAMED MANUFACTURER AND ARE BEING RESOLD BY THERMACUT. THERMACUT RESERVES THE RIGHT TO SUBSTITUTE OEM PARTS IN PLACE OF THERMACUT PARTS. VALID FROM SEPTEMBER 2016 • PREVIOUS VERSION IS NO LONGER VALID. • © COPYRIGHT 2016 BY THERMACUT® CZECH REPUBLIC. ALL RIGHTS RESERVED.

# REPLACEMENT PARTS SUITABLE FOR Hypertherm®

## HPR®130/HPR®260 Torches and Cable leads

| Item    | Part No. | Ref. No.       | Description   | Std. Pkg. | Item                       | Part No.  | Ref. No.         | Description  | Std. Pkg. |
|---------|----------|----------------|---|-----------|----------------------------|-----------|------------------|--|-----------|
| 1., 5.  | T-11137  | 220162         | Torch Q. D. Orig. design [incl. item 5 – 4 pcs; included 2pcs cooling tube 220340-UR] | 1         |                            | KT-1150   | 128988           | Cable Leads 20m (65ft)   | 1         |
| 1a.     | N-10096  | 1-028B         | O-Ring  | 1         |                            | KT-1270   | K.HPR130.21M.K   | Cable Leads 21m (69ft)   | 1         |
| 1b.     | N-10054  | 1-008S         | O-Ring  | 1         | !!!                        | KT-1245   | DEMO_HPR130      | Torch + cable leads 0,8m, for exhibition only, inoperative!  | 1         |
| 1c.     | N-18157  | N-18157        | Conical Sealing   | 1         | 1,2,5,6,7                  | KT-1331   | K.HPR130.7,5M    | Torch with Leads 7,5m (25ft)   | 1         |
| 1d.     | N-10534  | 60-246S        | O-Ring  | 1         | IEP 3,4,6,7                | KT-1066   | K.HPR130.7,5M-UR | Torch -UR with Leads 7,5m (25ft)   | 1         |
| 2.      | T-11138  | 220163         | Receptacle Q. D. Original design  | 1         | IEP 3,4,6,7                | KT-1082   | K.HPR130.15M-UR  | Torch -UR with Leads 15m (50ft)  | 1         |
| 2a.     | N-18108  | O-KR-45x3,5B   | O-Ring  | 1         | IEP 3,4,6,7                | KT-1076   | K.HPR130.18M-UR  | Torch -UR with Leads 18m (59ft)  | 1         |
| IEP #3. | T-10200# | 220162-UR      | Torch Q. D. Thermacut design [included 2pcs cooling tube 220340-UR]                   | 1         | 3,4,6,7                    | KT-1421   | K.HPR130.20M     | Torch with Leads 20m (65ft)  | 1         |
| IEP #4. | T-10201# | 220163-UR      | Receptacle Q. D. Thermacut design   | 1         | IEP 3,4,6,7                | KT-1075   | K.HPR130.21M-UR  | Torch -UR with Leads 21m (69ft)  | 1         |
| 5.      | T-11769  | T-11769        | Connector Tube HPR® with O-Rings  | 1         |                            |           |                  |  |           |
| 5a.     | N-10055  | 1-009S         | O-Ring  | 1         | 1a,<br>1b,<br>1c,<br>5, 5a | T-11864   | 128879           | Set of spare parts for 220162, contains items 5 (4 pcs), 5a (8 pcs), 1a (2 pcs), 1b (1 pc), 1c (1 pc), 2a (1 pc), cooling tube 220340-UR, silicon lubricant T-0994 | 1         |
| 6.      | T-10492  | 220232         | Mounting Tube   | 1         |                            |           |                  |  |           |
| 7.      | KT-1108  | 128986         | Cable Leads 2m (6ft)  | 1         |                            |           |                  |  |           |
|         | KT-1397  | 128935         | Cable Leads 3m (10ft)   | 1         |                            |           |                  |  |           |
|         | KT-1117  | 128934         | Cable Leads 4,5m (15ft)   | 1         | 1a, 1b,<br>1c, 1d          | T-11207   | 128879-UR        | Set of spare parts for 220162-UR, contains items 1a (2 pcs), 1b (1 pc), 1c (1 pc), 1d (4 pcs), 2a (1 pc), cooling tube 220340-UR, silicon lubricant T-0994         | 1         |
|         | KT-1052  | 128784         | Cable Leads 7,5m (25ft)   | 1         |                            |           |                  |  |           |
|         | KT-1126  | 128987         | Cable Leads 10m (35ft)  | 1         |                            |           |                  |  |           |
|         | KT-1106  | 128785         | Cable Leads 15m (50ft)  | 1         | ##8.                       | T-11409## | 220573           | Receptacle Q.D., Bevel   | 1         |
|         | KT-1269  | K.HPR130.18M.K | Cable Leads 18m (59ft)  | 1         | ##8a.                      | T-11410## | 220546           | Torch mounting sleeve, Bevel   | 1         |

# MUST BE USED ONLY AS A SET OF ITEMS 3 AND 4, THIS COMPLETE SET IS INTERCHANGEABLE AND COMPATIBLE WITH ORIGINAL PARTS

## RECEPTACLE Q.D., BEVEL POS. 8 IS NOT COMPATIBLE WITH STANDARD CABLE LEADS POS. 7

!!! DEMO IS INOPERATIVE, FOR EXHIBITION PURPOSES ONLY!

NS NOT SHOWN IN THE PICTURE

Q.D. QUICK DISCONNECT

ALL PARTS ARE WITH O-RINGS

IEP PLANNED END OF PRODUCTION 31<sup>ST</sup> DECEMBER 2017, PART WILL NOT BE AVAILABLE AFTER THIS DATE. PLEASE LEAVE THIS DESIGN AND SWITCH TO ITEMS 1, 2.

**Last update of this page: 02/09/2016. See Revision history for details.**

**THERMACUT®**  
THE CUTTING COMPANY

WWW.THERMACUT.CZ  
TEL.: +420 556 423 418  
SALES@THERMACUT.CZ

WWW.THERMACUT.DE  
TEL.: +49 (0) 27 39 40 33 0  
INFO@THERMACUT.DE

WWW.THERMACUT.COM  
TEL.: 1-603-542-6715  
CUSTOMERSERVICE@THERMACUT.COM

THERMACUT®, FHT-EX® AND EX-TRAFIRE® ARE REGISTERED TRADEMARKS OF THERMACUT S. R. O. AND MAY BE REGISTERED IN CZECH REPUBLIC AND/OR OTHER COUNTRIES. ALL OTHER TRADEMARKS ARE PROPERTIES OF THEIR RESPECTIVE OWNERS. THERMACUT IS NO WAY AFFILIATED WITH Hypertherm®. MOST THERMACUT PARTS ARE MADE FOR OR BY AN IBG COMPANY. PARTS INDICATED WITH A OEM ARE ORIGINAL PARTS MANUFACTURED BY THE ABOVE NAMED MANUFACTURER AND ARE BEING RESOLD BY THERMACUT. THERMACUT RESERVES THE RIGHT TO SUBSTITUTE OEM PARTS IN PLACE OF THERMACUT PARTS. VALID FROM SEPTEMBER 2016 • PREVIOUS VERSION IS NO LONGER VALID. • © COPYRIGHT 2016 BY THERMACUT® CZECH REPUBLIC. ALL RIGHTS RESERVED.