

# **THERMACUT SMART SOLUTION FOR PLASMA CUTTING SYSTEM KJELLBERG® PERCUT® 210 KJELLBERG® PERCUT® 450M**

## **FEATURES**

- REDESIGNED SHAPE OF NOZZLE
- EASY ASSEMBLY OF CONSUMABLE PARTS
- ELIMINATION 5 GROOVE ORIENTATION OF OEM NOZZLE

## **BENEFITS**

- EXCELLENT CUT QUALITY
- BETTER COST EFFECTIVENESS OF YOUR SYSTEM
- EXTENSION OF THE LIFETIME OF THE CONSUMABLES
- IMPROVED COOLING ON OUTER SURFACE OF THE NOZZLE
- CATHODE, COOLING TUBE AND SWIRL RING ARE FULLY INTERCHANGEABLE WITH OEM PARTS



# THERMACUT SMART SOLUTION FOR KJELLBERG® PERCUT® 210 AND PERCUT® 450M

YEARS OF EXPERIENCE, LIFE TESTING, UNIQUE IMPROVED DESIGN AND THE EFFORT TO IMPROVE THE SPEED AND CUT QUALITY OF YOUR PLASMA CUTTING SYSTEM. THIS IS WHY THERMACUT STRIVES TO BRING **SMART SOLUTION** TO OUR CUSTOMERS WHENEVER POSSIBLE.

## THE SIMPLE SHAPE OF THERMACUT NOZZLES

SIMPLY INSERT THE NOZZLE INTO THE TORCH  
UNLIKE THE OEM NOZZLE CONSTRUCTION WHERE THE NOZZLE MUST BE ORIENTATED INTO FIVE GROOVES IN THE TORCH! MOREOVER - THE SIMPLE NOZZLE SHAPE MINIMIZES THE DANGER CAUSED BY IMPROPER ASSEMBLY OF THE PARTS WHICH COULD CAUSE DAMAGE TO THE TORCH.

### OEM NOZZLE

HAS TO BE ORIENTATED INTO THE FIVE GROOVES IN THE TORCH.

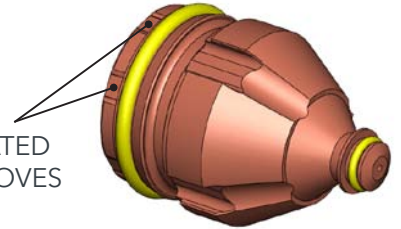

### THE THERMACUT NOZZLE

DESIGN DOES NOT NEED TO BE ORIENTATED INTO GROOVES.

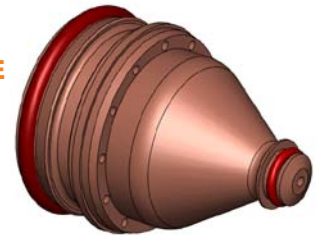

## EASY ASSEMBLY

ELECTRODE, COOLING TUBE AND SWIRL RING ARE FULLY INTERCHANGEABLE WITH OEM PARTS.

## UNIQUE CONSTRUCTION OF CONSUMABLES COOLING SYSTEM

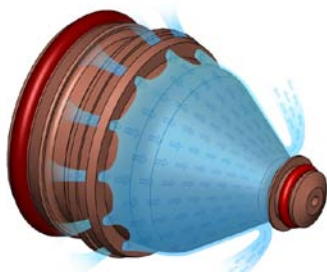

WE DESIGNED THE NOZZLE COOLING SO THAT THE LARGEST AREA OF THE OUTER SURFACE IS COOLED CLOSEST TO THE HEAT SOURCE OF PLASMA ARC.

THIS UNIQUE CONSTRUCTION DESIGN OFFERS MAXIMUM COOLING OF THE NOZZLE SURFACE, THIS UNIQUE DESIGN HELPS TO CONDUCT THE HEAT BETTER AND THEREBY EXTENDING THE LIFETIME OF CONSUMABLES.



**c** MUST BE USED ONLY AS A SET OF SWIRL GAS CAP, RETAINING CAP AND NOZZLE. IF THESE THREE PARTS ARE USED AS A SET, THE REMAINING CONSUMABLES CAN BE OEM.

## A GLOBAL PROVIDER OF THERMAL CUTTING TECHNOLOGY

**THERMACUT®**  
THE CUTTING COMPANY®

THERMACUT GMBH  
ESSENER STR. 1 - D-57234 WILNSDORF  
PHONE: +49 (0)2734 4033-0  
E-MAIL: [INFO@THERMACUT.DE](mailto:INFO@THERMACUT.DE), [WWW.THERMACUT.DE](http://WWW.THERMACUT.DE)

THERMACUT®, SILVEREX-®, FHT-EX® AND EX-TRAFIRE® ARE REGISTERED TRADEMARKS OF THERMACUT, K. S. AND MAY BE REGISTERED IN CZECH REPUBLIC AND/OR OTHER COUNTRIES. ALL OTHER TRADEMARKS ARE PROPERTIES OF THEIR RESPECTIVE OWNERS. THERMACUT IS NO WAY AFFILIATED WITH KJELLBERG®.

